

UNIVERSITY PLACE

820 South University Boulevard, Mobile, Alabama

FOR LEASE

OVERVIEW

AERIAL

SITE PLANS

MAP



Description

University Place is an office park consisting of four buildings conveniently located on University Boulevard between Cottage Hill Road and Airport Boulevard in Mobile, Alabama. There are many different space options available with the possibility of up to 12,000 contiguous square feet. University Place is owned by local investors who are committed to keeping the property in first class condition. Please call for further details.

Property Information

- Office Class: B
- Office Type: Business Park
- Building Size: 55,000 +/- SF
- Number of Buildings: 4
- Number of Floors: 1
- Year Renovated: 2016

Available

- Minimum Divisible: 1,000 SF
- Maximum Contiguous: 12,000 SF

Price

- Price: \$14.50 PSF Modified Gross

Nathan D. Handmacher

direct: 251-370-0256 / cell: 251-375-2498 / nhandmacher@stirlingprop.com



www.StirlingProperties.com



RETAIL BROKERS NETWORK

The foregoing is solely for information purposes and is subject to change without notice. Stirling Properties makes no representations or warranties regarding the properties or information herein including but not limited to any and all images pertaining to these properties. It is the obligation of each purchaser/lessee to investigate the condition and attributes of the properties and to verify the accuracy of the foregoing information to the extent such purchaser/lessee deems necessary. Also subject to errors, omissions, changes in terms and conditions, prior sale, lease or withdrawal, without notice. 09/16

UNIVERSITY PLACE

820 South University Boulevard, Mobile, Alabama

FOR LEASE

OVERVIEW

AERIAL

SITE PLANS

MAP



Nathan D. Handmacher

direct: 251-370-0256 / cell: 251-375-2498 / nhandmacher@stirlingprop.com



www.StirlingProperties.com



RETAIL BROKERS NETWORK

The foregoing is solely for information purposes and is subject to change without notice. Stirling Properties makes no representations or warranties regarding the properties or information herein including but not limited to any and all images pertaining to these properties. It is the obligation of each purchaser/lessee to investigate the condition and attributes of the properties and to verify the accuracy of the foregoing information to the extent such purchaser/lessee deems necessary. Also subject to errors, omissions, changes in terms and conditions, prior sale, lease or withdrawal, without notice. 09/16

UNIVERSITY PLACE

820 South University Boulevard, Mobile, Alabama

FOR LEASE

OVERVIEW

AERIAL

SITE PLANS

MAP

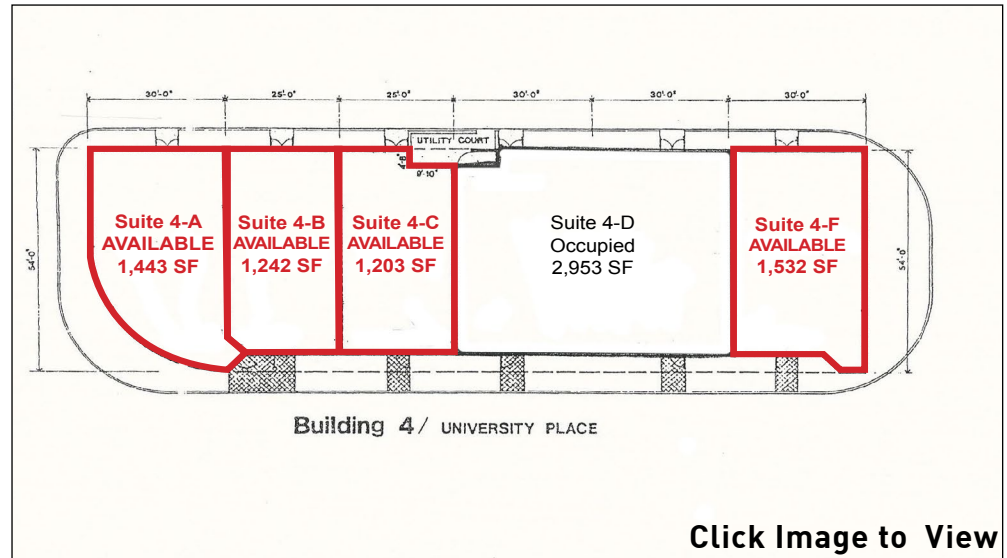
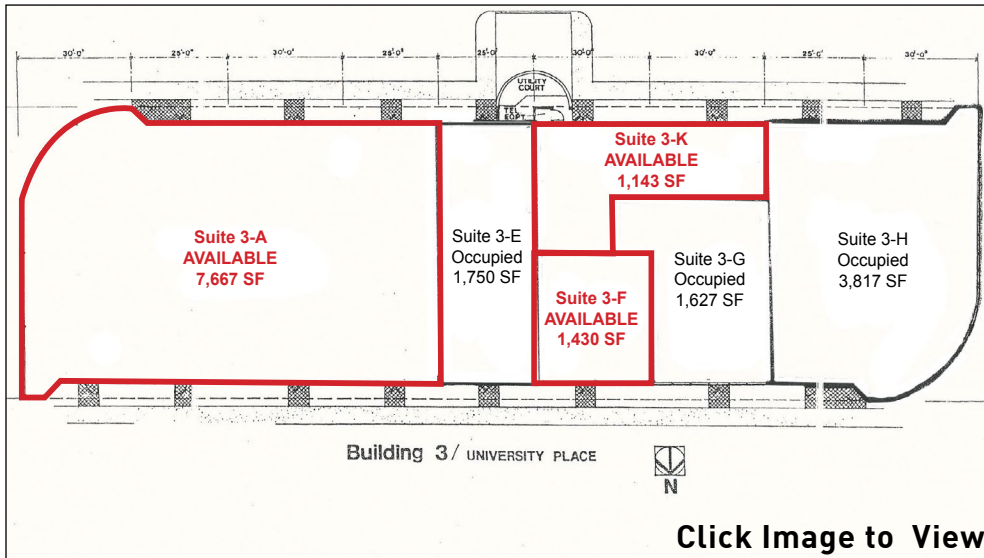
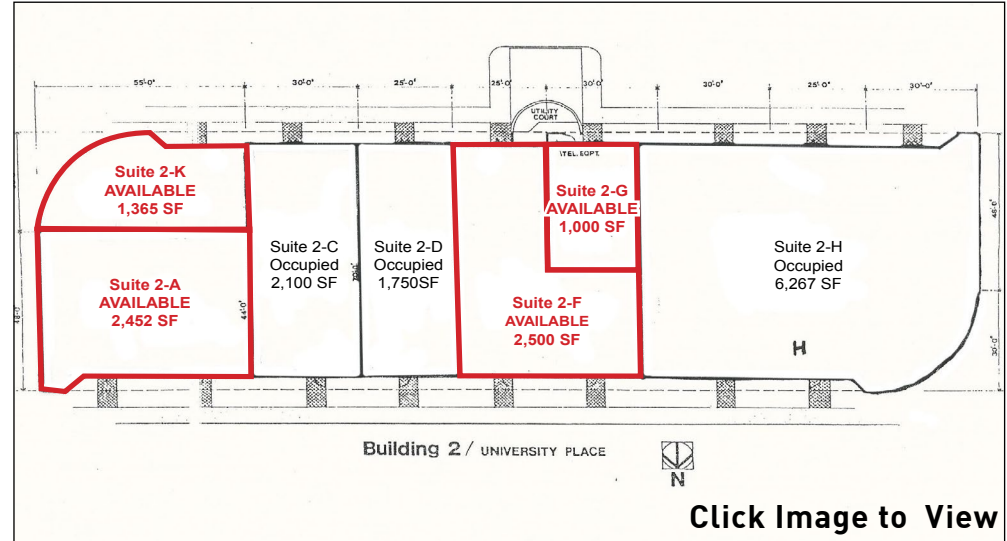
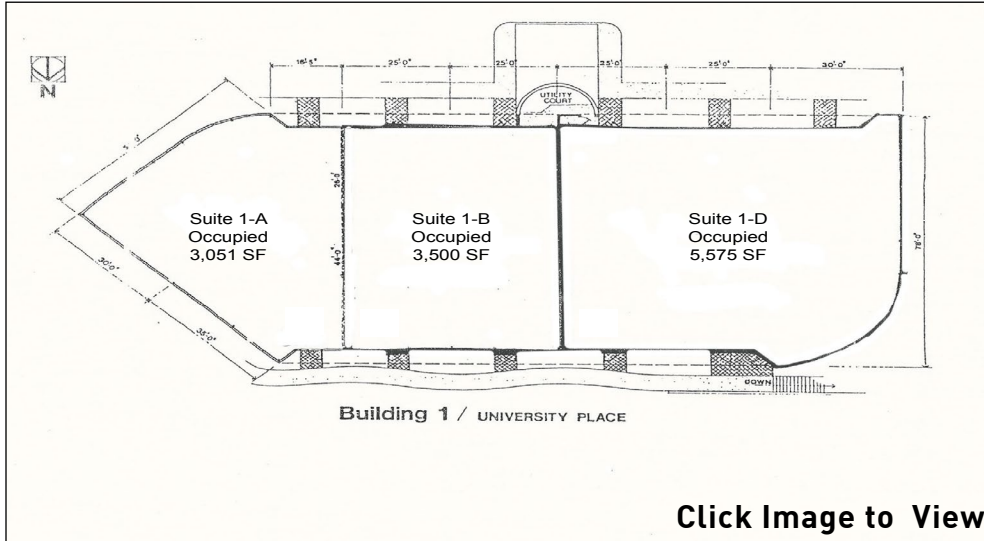

Nathan D. Handmacher

direct: 251-370-0256 / cell: 251-375-2498 / nhandmacher@stirlingprop.com



www.StirlingProperties.com



RETAIL BROKERS NETWORK

The foregoing is solely for information purposes and is subject to change without notice. Stirling Properties makes no representations or warranties regarding the properties or information herein including but not limited to any and all images pertaining to these properties. It is the obligation of each purchaser/lessee to investigate the condition and attributes of the properties and to verify the accuracy of the foregoing information to the extent such purchaser/lessee deems necessary. Also subject to errors, omissions, changes in terms and conditions, prior sale, lease or withdrawal, without notice. 09/16

UNIVERSITY PLACE

820 South University Boulevard, Mobile, Alabama

FOR LEASE

OVERVIEW

AERIAL

SITE PLANS

MAP



Nathan D. Handmacher

direct: 251-370-0256 / cell: 251-375-2498 / nhandmacher@stirlingprop.com

www.StirlingProperties.com



RETAIL BROKERS NETWORK



The foregoing is solely for information purposes and is subject to change without notice. Stirling Properties makes no representations or warranties regarding the properties or information herein including but not limited to any and all images pertaining to these properties. It is the obligation of each purchaser/lessee to investigate the condition and attributes of the properties and to verify the accuracy of the foregoing information to the extent such purchaser/lessee deems necessary. Also subject to errors, omissions, changes in terms and conditions, prior sale, lease or withdrawal, without notice. 09/16